

High impact tank cleaning machine

MeshClean+

Series 5T5



Features:

- High efficiency thanks to especially powerful solid jet nozzles
- Also suitable for large tanks with persistent soiling
- Active self-cleaning through special nozzle geometry
- Particularly low-maintenance



Function video
www.lechler.com/de-en/medialibrary/videos-general-industry
 Or scan the QR code.

Series 5T5

Technical data:

Maximum operating temperature 150 °C 150 °C (ATEX)	Maximum ambient temperature 150 °C 150 °C (ATEX)	Installation Operation in every installation position	Bearing Ball bearing
Material Stainless steel 1.4404 (316L), PTFE, PEEK, EPDM or FKM	Weight 4.0 kg	Surface quality Ra ≤ 0.8 µm <small>OUTSIDE</small>	Surface quality Ra ≤ 1.6 µm <small>INSIDE</small>
Steam suitability Suitable	Insertion diameter 120 mm	Recommended filter Line strainer with a mesh size of 0.2 mm/80 mesh	Recommended operating pressure 5 bar
Adapter 1 1/2 BSPP is compatible with HygienicFit	Rotation monitoring Sensor-compatible, information: see pages 100–101	Maintainable	

Max. tank diameter
 The specified maximum tank diameter applies to the recommended operating pressure and is indicative only. The type of soiling is also decisive for the cleaning result.

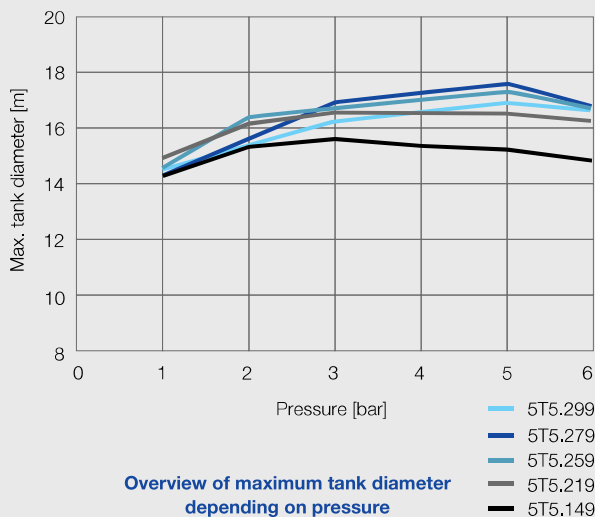

Duration of cleaning cycle

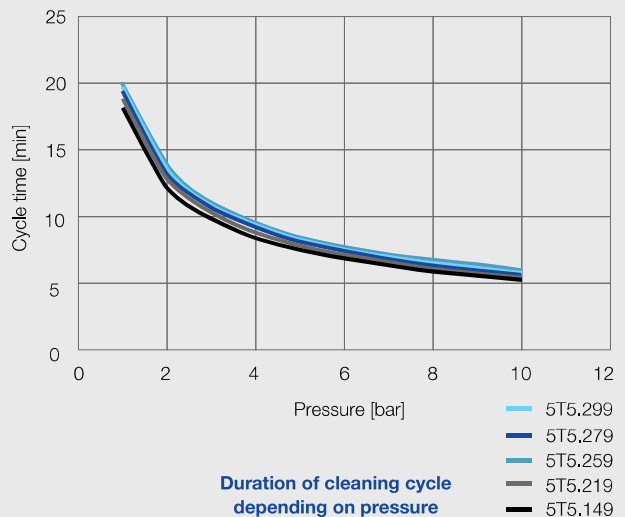

Dimensions in mm.

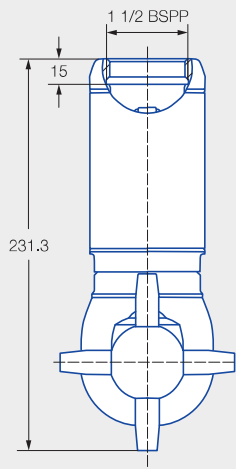

Female thread

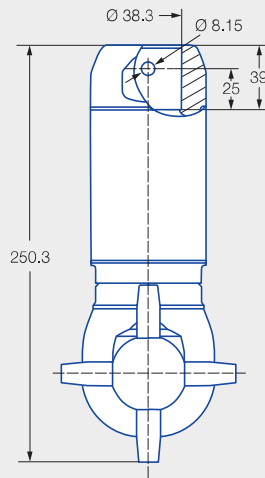

Dimensions of slip-on connection according to ASME-BPE (OD tube)

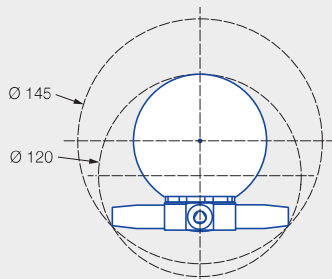

Insertion diameter and interference circle diameter of the threaded connection

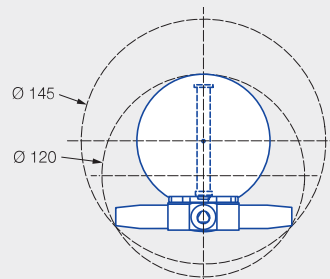

Insertion diameter and interference circle diameter of the slip-on connection

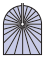
Spray angle	Ordering no.					Narrowest cross-section \varnothing [mm]	Quantity x \varnothing nozzle [mm]	\dot{V} water [l/min]				\dot{V} water at 5 bar [m ³ /h]	Max. tank diameter [m]
	Type	Connection						p [bar] ($p_{max} = 15$ bar)					
		1 1/2 BSPP		1 1/2" slip-on connection				2.0	3.0	5.0	10.0		
		EPDM	FKM	EPDM	FKM								
360° 	5T5.149.1Y	AS	25	TF15	34	4.40	4 x 4.40	70	86	111	157	6.6	15.2
	5T5.219.1Y	AS	25	TF15	34	5.55	4 x 5.55	107	131	169	239	10.1	16.5
	5T5.259.1Y	AS	25	TF15	34	6.45	4 x 6.45	132	162	209	296	12.5	17.3
	5T5.279.1Y	AS	25	TF15	34	7.10	4 x 7.10	150	184	238	336	14.2	17.6
	5T5.299.1Y	AS	25	TF15	34	7.75	4 x 7.75	170	209	269	380	16.1	16.9

NPT threads on request.

Information on operation

Compressed air can be used only for a short time for blowing dry. Use above the recommended pressure will have a negative effect on the cleaning result and wear.

Ordering example with FDA and (EC) 1935/2004 conformity.

All materials are suitable for contact with food.



Type + Connection = Ordering no.
5T5.149.1Y + AS = 5T5.149.1Y.AS

Ordering example with ATEX approval. FDA and (EC) 1935/2004 conformity.

Unit group/Category/Zones:

- Ex II 1G Ex h IIB T6...T3 Ga
- Ex II 1D Ex h IIIC T85 °C...T190 °C Da



Important

The code for the connection changes for the ATEX version with slip-on connection.

Ordering example for 1 1/2" slip-on connection: 5T5.149.1Y.T5.EX



Type + Connection + ATEX = Ordering no.
5T5.149.1Y + AS + EX = 5T5.149.1Y.AS.EX